



RADIO CONTROL TVPRH

ATTENTION !

The appliance must be installed only by qualified technical personnel in compliance with the standards in force. All connections must be rated for a 230V single-phase power supply. To disconnect the appliance from the mains use an all-pole switch with a minimum distance of 3.5 mm between the contacts. All wiring used must guarantee sufficient insulation as required by electrical safety standards in force.

The programmer only carries out remote and manual movement commands. All the necessary safety devices required by the installation are to be organised separately. The programmer is in conformity with the RAEE and RoHS directives and it is intended for indoor use only (IPX0). The appliance is not intended for use by people (including children) with reduced physical, sensorial or mental facilities, or with a lack of experience or knowledge, unless they are supervised by a person responsible for their safety or instruction concerning the use of the appliance. Children must be supervised to ensure that they do not play with the appliance.

The radio frequency reception of the appliance may be disturbed by several factors as follows:
-radio electric interferences from other appliances in the same room that are transmitting on the same frequency
-if the appliance is housed in a metal casing; only plastic casing should be used.

1- GENERAL DESCRIPTION

Electronics for the remote control of tubular motors for rolling shutters with mechanical or electronic travel limits incorporated in the motor. Possibility to control the device manually or via radio (in the 868 version). The work time is fixed at 60 seconds. Programming is either carried out on the receiver or remotely via transmitters. This appliance may be commanded by the standard transmitters of the series TVLink. The standard transmitters may be memorized or cancelled in the receiver using the command buttons. The maximum number of codes that can be memorized is 42 .

1.1 Operating mode

It is possible to select different functioning modes. The operating mode involves both the commands by means of push-buttons and the commands via radio. These phases are possible only for the first 10 seconds after having given power to the device.

1.1.1 Automatic opening and closing movement

1) Give power to the device, the Led1 will light up for two seconds.
2) After the two seconds, press at the same time the push-buttons P2+P4 for 8 times and hold them pressed for two seconds. The Led will light up every time the push-buttons will be pressed.

1.1.2 Automatic opening movement and “present man” closing movement

1) Give power to the device, the Led1 will light up for two seconds.
2) After the two seconds, press at the same time the push-buttons P2+P4 for 9 times and hold them pressed for two seconds. The Led will light up every time the push-buttons will be pressed.

1.1.3 “Present man” opening and closing movement

1) Give power to the device, the Led1 will light up for two seconds.
2) After the two seconds, pressh at the same time the push-buttons P2+P4 for 10 times and hold them pressed for two seconds. The Led will light up every time the push-buttons will be pressed.

2- Transmitters

Use transmitters with at least 2 channels.

The transmitters are pre-coded by the manufacturer and each transmitter has its own unique code.

Attention: if you press and hold down a transmitter button for more than 30 seconds, the transmitter with switch off automatically.

The receiver is compatible with all transmitters of the TVLink system: TVTXV, TVTXP, TVTXC, TVTXK, TVTXQ, TVTXL.

3- Memorizing transmitters (we suggest that you cancel the entire memory content before a new installation)

When the buttons P2+P4 are used at the same time (programming functions) the led lights up each time.

The channels are memorized in pairs, ch1 with ch2, ch3 with ch4, ch5 with ch6 and ch7.

3.1- Memorizing directly on the receiver

1) Press buttons P2+P4 simultaneously for 3 times and then hold them down, the led will light up and remain lit.

2) Transmit one of the two channels of the pair to be memorized. Once memorized the led will flash intermittently, release the button.

To insert another pair of channels on the receiver repeat points 1 and 2.

3.2- To cancel a code on the receiver:

1) Press buttons P2+P4 simultaneous for 4 times and then hold them down, the receiver led will flash intermittently slowly.

2) Transmit one of the two channels of the pair to be cancelled, once cancelled, the led will light up and remain lit.

To cancel more transmitters repeats points 1-2

3.3- To cancel all codes from memory:

Simultaneously press buttons P2+P4 for 5 times and hold them down for at least ten seconds, the receiver led will flash rapidly. Once the memory has been cancelled the led will light up and remain lit.

4 - Memorizing via a transmitter (first installation, empty memory)

1) Press button P3 on the transmitter, the receiver led will light up and remain lit.

2) Transmit one of the two channels of the pair to be memorized. Once memorized the led will flash intermittently, release the button.

To insert another pair of channels via radio follow the procedure in paragraph 4.1

4.1 - Memorizing via a transmitter (ulterior transmitters) (memory addressing procedure)

1) Press button P3 on the already memorized transmitter, the receiver led will light up and remain lit.

2) Within 5 seconds press a channel that is already memorized in the receiver, the led will switch off for 1 second and then light up again for 5 seconds.

3) Transmit one of the two channels of the pair to be memorized. Once memorized the led will flash intermittently, release the button.

To memorize more transmitters repeats points 1-2-3.

4.2- To cancel a code via radio

1) Press button P3 on the transmitter for three times within five seconds, the receiver led will flash slowly.

2) Transmit one of the two channels of the pair to be cancelled, once cancelled, the led will switch off.

5- If memory is full

If the memory is full the led will flash three times when you are attempting to memorize.

5.1- Errors during memorizing or cancelling

If the code is not memorized it could be due to one of the following:

- the code already exists in memory;
- the memory is full;
- the addressing procedure has not been followed correctly.

TVPRH	TVLink RS868		T303.01	
-------	--------------	--	---------	--

6- TECHNICAL SPECIFICATION

Reception frequency	868.3 MHz
Intermediate frequency	10.7MHz
Sensitivity (with a finely tuned signal)	1 μ V
Power supply	230 V
Relay output	
Voltage	230 V
Power	400 W
Operating temperature	-20° - + 50 °C

The reported data refer to the command of tubular motors with max. 4 minutes working time.

AVAILABLE MODELS

TVPRH000A01 only push buttons version

TVPRH868A01 remote and push buttons version

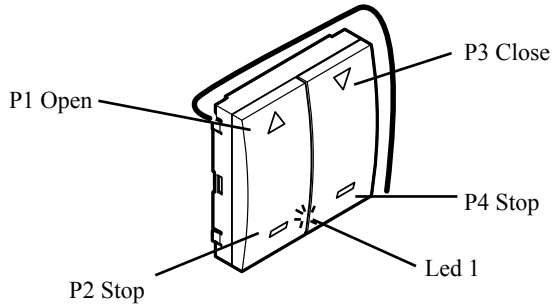

TRANSMITTERS

TVTXC868A04

TVTXP868A02-04

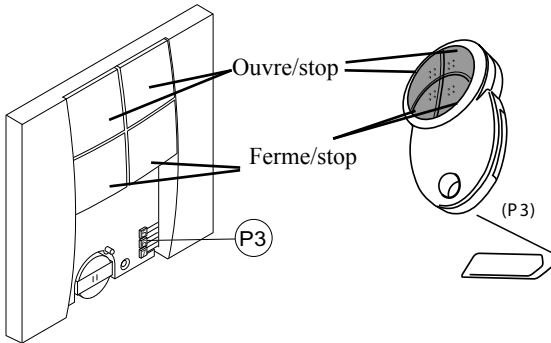

TVTXW868A04

TVTXW868A03

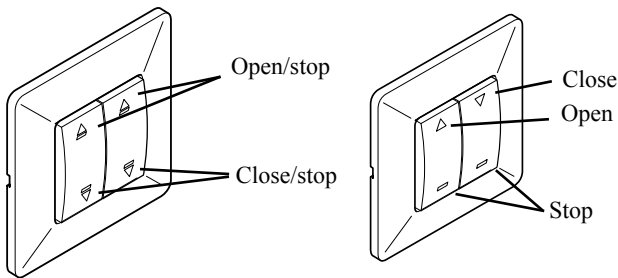

TVTXQ868A03/18

TVTXQ868A07/42

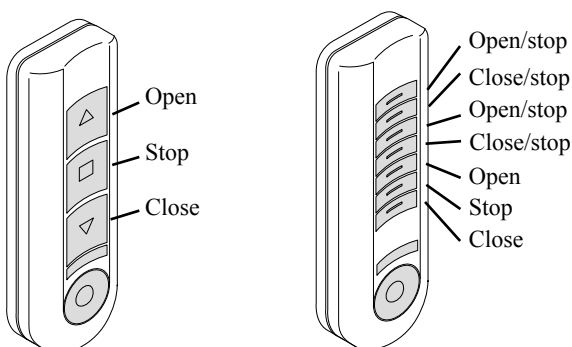

CONNECTIONS

- 1 Power supply 230V line
- 2 Power supply 230V neutral
- 3 Motor common (neutral)
- 4 Motor closing command
- 5 Motor opening command

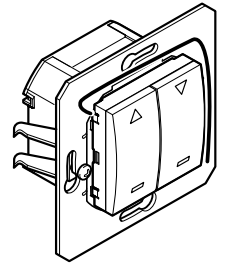

Take care to respect the neutral wire connection.

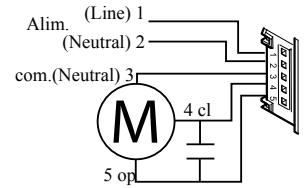

ASSEMBLY

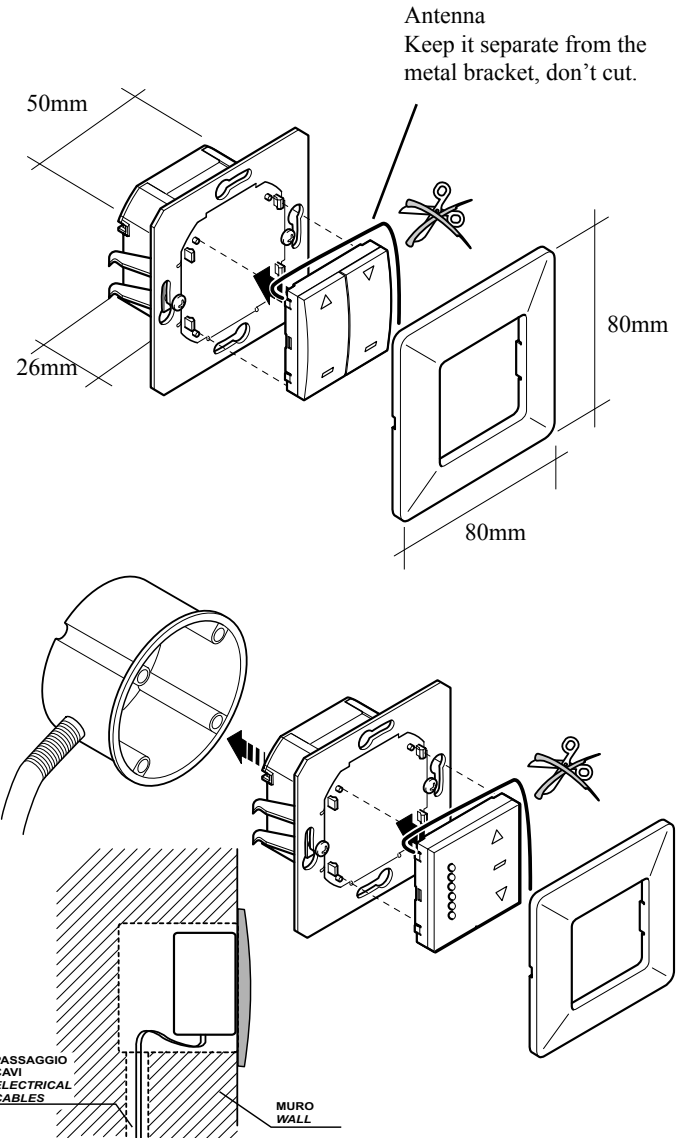

The appliance must be installed either by means of the fastening screws or the lateral hooks. Strip the wires as little as possible and block them in position near the binding posts using plastic clips. Fasten the wires well so that they cannot slip out of their binding posts.

As these products are being continuously developed, the manufacturer reserves the right to modify the technical specifications and performance characteristics without notice.