

INSTRUCTION MANUAL

Before using our 10W LED light engine, please read below instruction carefully. Any problems, please contact with us.

10W-LED Light engine guarantee one year.

SAFE WARNING:

1. Check supply voltage, whether it matches light engine.
2. Prohibit to place the machine under rain or wet spot, prevent from causing troubles or danger of electric shock.
3. Light engine should be used in a draughty surrounding, not stack other things around it.

PARAMETER:

Supply voltage: 100 V -265 V /AC

Power frequency: 50Hz-60Hz

Power: 16w

Body Measurement: L122* W88* H38 mm
(without connector)

Operation Illustration:

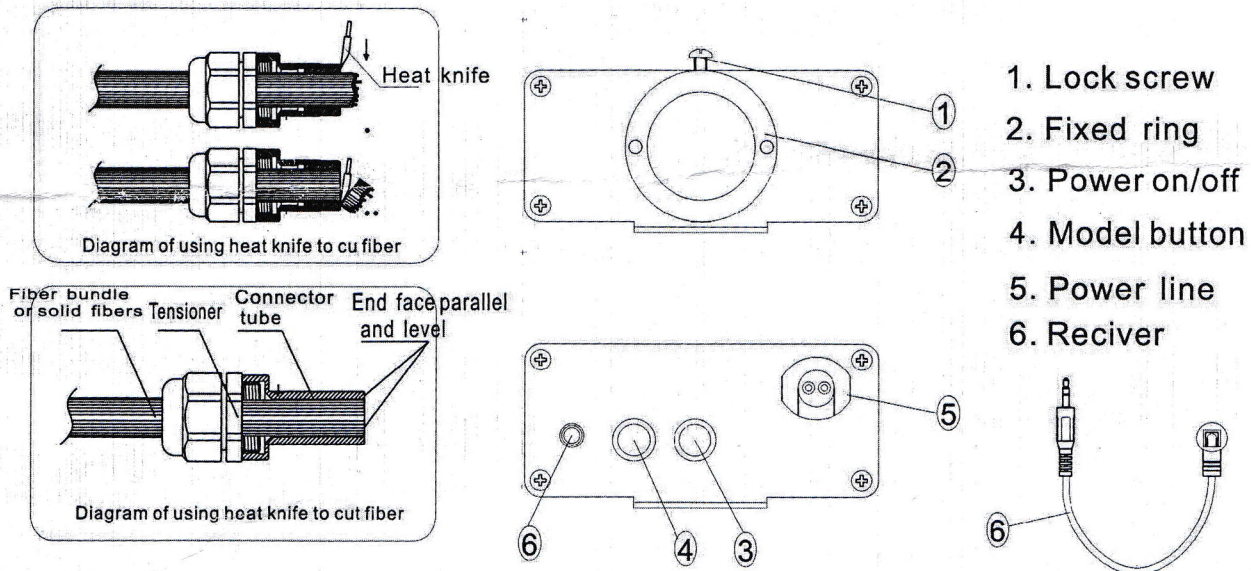

Program option:

About the model button:

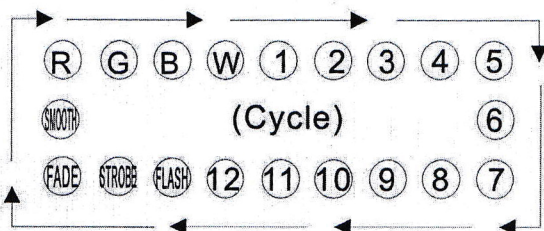

For example, if you using **FADE**, press the model button, it will turns to **SMOOTH**, press again, turns to **R**

